

SITE PLAN

Electrical sub panels @ master Bed Room Behind Door
 main - near Apt 201

water Heaters - A/C on Roof

Access Door near Apt 201

- clean outs - Backyard near storage Room per unit
- electrical - 1 panel per Building Backyard
- water shut off valve Back yard by faucet per unit

CAL 28-07

Helsem Terrace - Kerman

40 Units (227 - 266)
 Constructed 1953
 20 bldgs. w/2 units/bldg.
 Unit # is the identifier
 Sidewalks - 12,650 Sq. Ft.
 Parking Area - 23,500 Sq. Ft.

UNIT ADDRESS

227	938 S. Ninth Street (3)
228	930 S. Ninth Street (3)
229	14595 W. "B" Street (1)
230	14593 W. "B" Street (4)
231	14587 W. "B" Street (3)
232	14589 W. "B" Street (3)
233	14581 W. "B" Street (3)
234	14579 W. "B" Street (3)
235	14577 W. "B" Street (2)
236	14575 W. "B" Street (2)
237	14571 W. "B" Street (3)
238	14573 W. "B" Street (3)
239	14567 W. "B" Street (3)
240	14565 W. "B" Street (3)
241	14561 W. "B" Street (1)
242	14559 W. "B" Street (4)
243	14553 W. "B" Street (3)
244	14551 W. "B" Street (3)
245	14545 W. "B" Street (3)
246	14543 W. "B" Street (3)
247	14541 W. "B" Street (1)
248	14539 W. "B" Street (4)
249	14540 W. "B" Street (2)
250	14542 W. "B" Street (2)
251	14548 W. "B" Street (4)
252	14550 W. "B" Street (1)
253	14554 W. "B" Street (2)
254	14552 W. "B" Street (2)
255	14560 W. "B" Street (2)
256	14562 W. "B" Street (2)
257	14570 W. "B" Street (2)
258	14568 W. "B" Street (2)
259	14574 W. "B" Street (2)
260	14576 W. "B" Street (2)
261	14584 W. "B" Street (2)
262	14582 W. "B" Street (2)
263	14590 W. "B" Street (2)
264	14592 W. "B" Street (2)
265	880 S. Ninth Street (2)
266	14596 W. "B" Street (2)

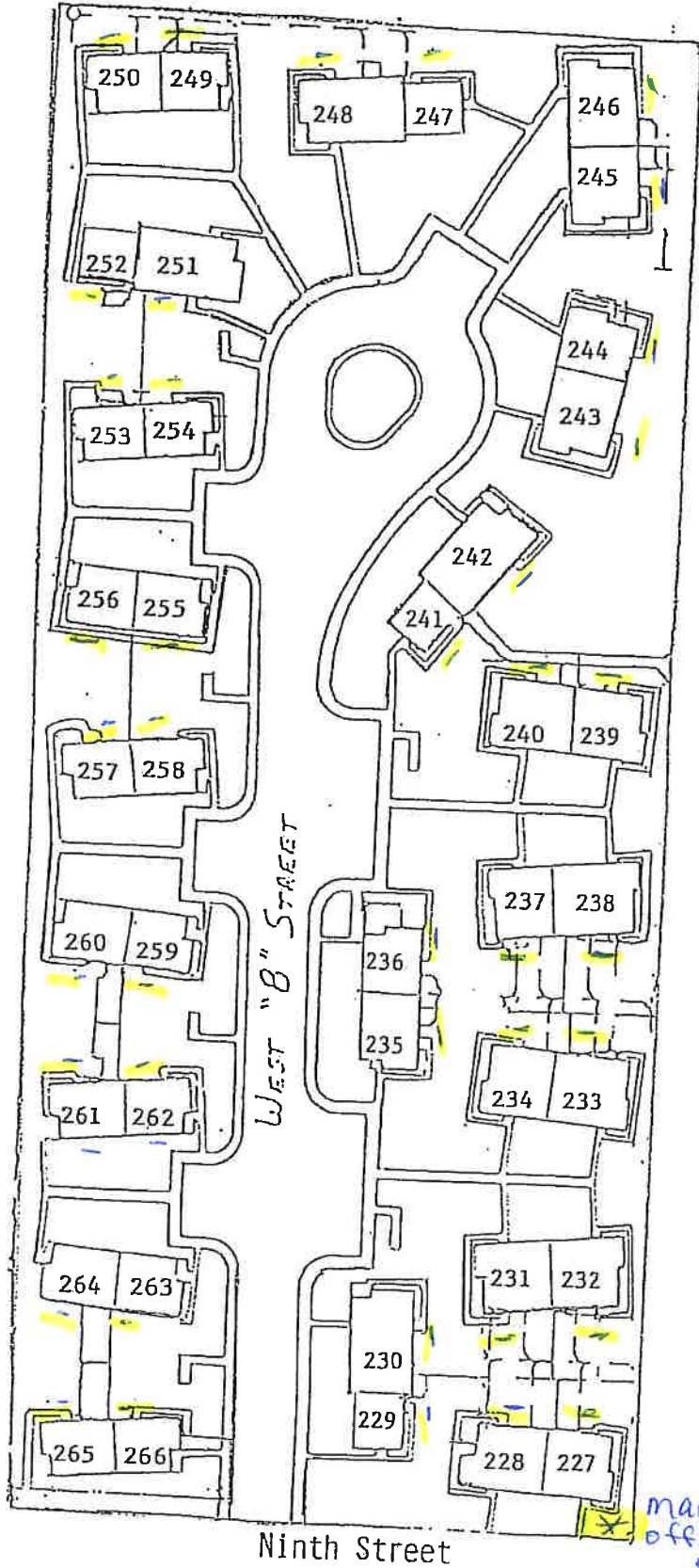

1 Bdrm. - 4
2 Bdrm. - 18
3 Bdrm. - 14
4 Bdrm. - 4

main water shut off. call city
 559-846-6363

CAL. 28-10

Taylor Terrace - San Joaquin

28 Units (155 - 182)
 Constructed 1953
 14 bldgs. w/2 units/bldg.

Unit # is identifier
 Sidewalks - 2,430 Sq. Ft.
 Parking Area - 5,388 Sq. Ft.

UNIT	ADDRESS	UNIT	ADDRESS
155	8410 Fifth Street (2)	169	8417 Sixth Street (3)
156	22199 Nevada Ave. (2)	170	8419 Sixth Street (3)
157	8412 Fifth Street (3)	171	8427 Sixth Street (3)
158	8414 Fifth Street (3)	172	8425 Sixth Street (3)
159	8420 Fifth Street (2)	173	8429 Sixth Street (1)
160	8422 Fifth Street (2)	174	8431 Sixth Street (4)
161	8432 Fifth Street (2)	175	8433 Sixth Street (2)
162	8434 Fifth Street (2)	176	8435 Sixth Street (2)
163	8430 Fifth Street (1)	177	8421 Sixth Street (2)
164	8428 Fifth Street (4)	178	8423 Sixth Street (2)
165	8424 Fifth Street (3)	179	8415 Sixth Street (3)
166	8426 Fifth Street (3)	180	8413 Sixth Street (3)
167	8418 Fifth Street (3)	181	22169 Nevada Ave. (2)
168	8416 Fifth Street (3)	182	8411 Sixth Street (2)

1 Bdrm. -2	2 Bdrm. -12	3 Bdrm. -12	4 Bdrm. -2	5 Bdrm. -0
------------	-------------	-------------	------------	------------

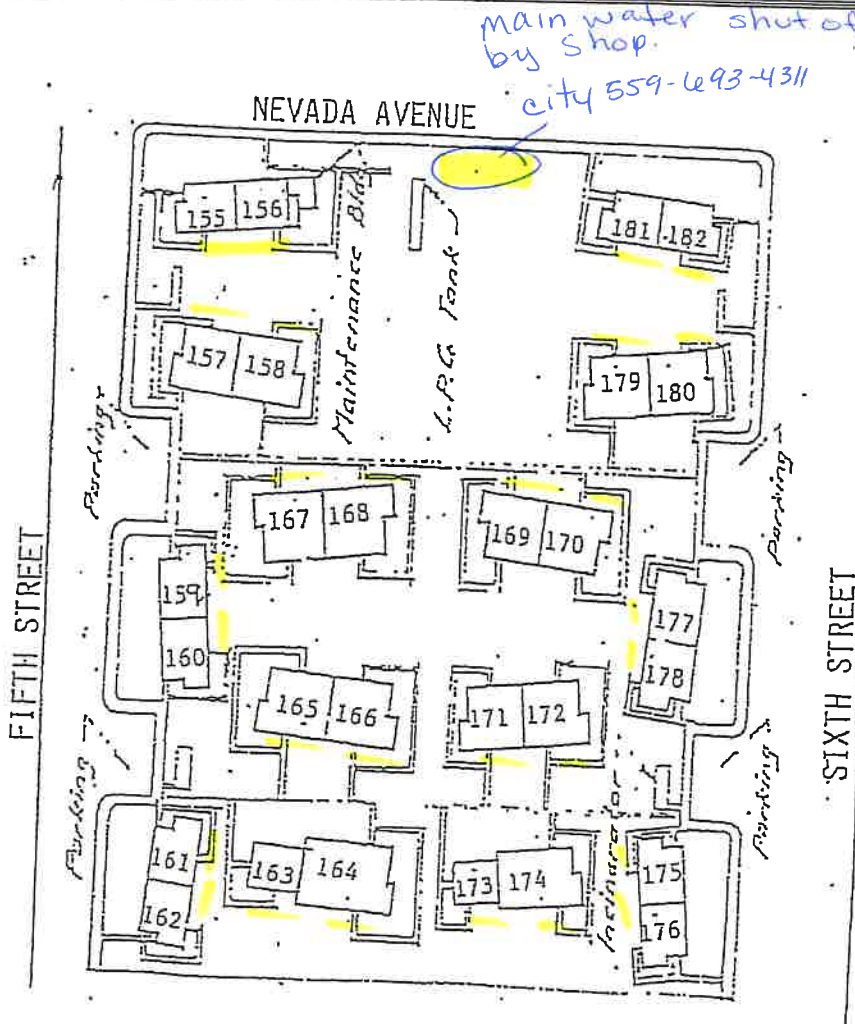

CAL. 28-21

San Joaquin Apartments - San Joaquin

20 Units (341 - 360)
 Constructed 1968
 6 Bldgs. w/2 units/bldg.
 8 Bldgs. w/1 unit/bldg.
 Unit # is the Identifier
 Sidewalks - 5,560 Sq. Ft.
 Parking Area - 5,798 Sq. Ft.

+ clean out
 - water shut off valve - next to water hose
 M electrical - side of Building
 Sub panel - inside unit

UNIT ADDRESS

341	8610 Pine Street (2)
342	8620 Pine Street (2)
343	22297 W. Idaho Street (3)
344	22295 W. Idaho Street (3)
345	22293 W. Idaho Street (4)
346	22285 W. Idaho Street (4)
347	22279 W. Idaho Street (4)
348	22275 W. Idaho Street (3)
349	22273 W. Idaho Street (3)
350	22277 W. Idaho Street (4)
351	22281 W. Idaho Street (3)
352	22283 W. Idaho Street (3)
353	22289 W. Idaho Street (3)
354	22287 W. Idaho Street (3)
355	22291 W. Idaho Street (4)
356	22211 W. Idaho Street (3)
357	22209 W. Idaho Street (3)
358	8710 S. Pine Street (5)
359	8720 S. Pine Street (4)
360	8730 S. Pine Street (5)

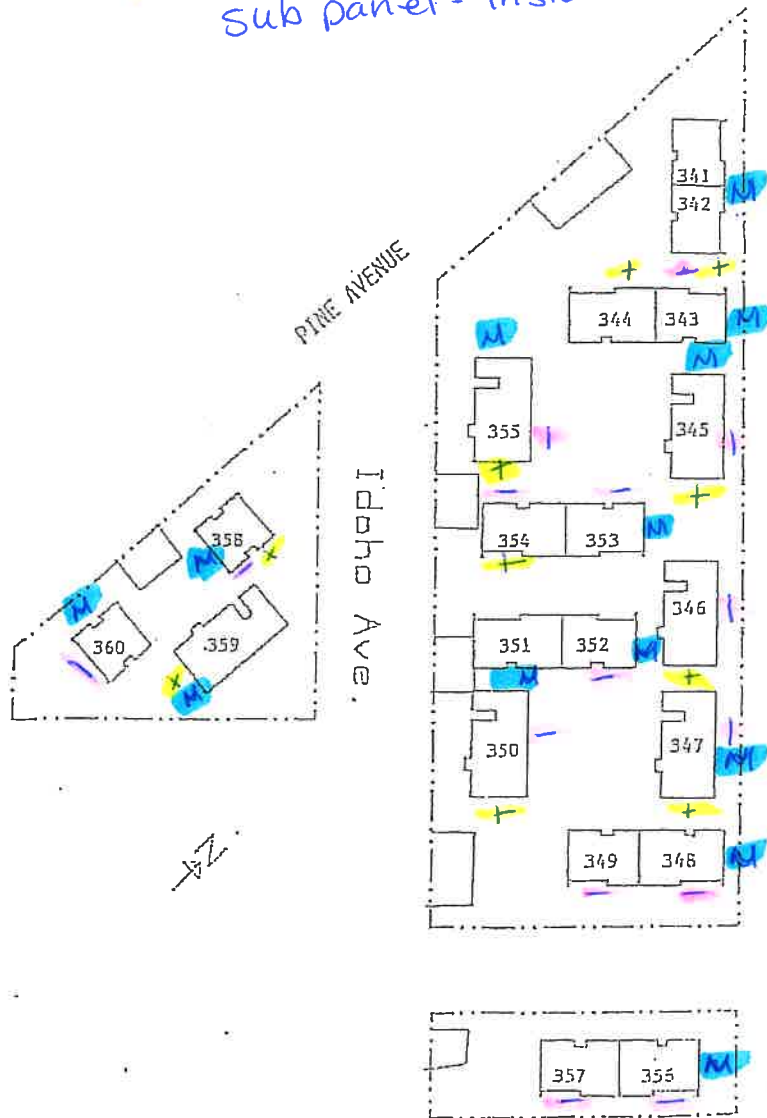

1 Bdrm.	- 0
2 Bdrm.	- 2
3 Bdrm.	- 10
4 Bdrm.	- 6
5 Bdrm.	- 2